

EN

# Mon Soleil DSP Frame Wi-Fi

360 / 600 / 720

User manual



Model: Mon Soleil DSP Frame Wi-Fi Date: 16/09/2025  
Version: v5.0

**EUROM**<sup>®</sup>  
POWERFUL PRODUCTS SINCE 1974

This product is only suitable for well insulated spaces or occasional use.

---

Model:	Product code:
Mon Soleil DSP Frame 360 Wi-Fi	361957
Mon Soleil DSP Frame 600 Wi-Fi	361971
Mon Soleil DSP Frame 720 Wi-Fi	361995

---

**Wi-Fi thermostat (OPTIONAL)**

---

Wi-Fi thermostat	365764
Wi-Fi thermostat (Swiss plug)	365771
Wi-Fi thermostat USB-C	365788

---

**Freestanding support (OPTIONAL)**

---

Freestanding support	361278
----------------------	--------

---

## Mandatory warnings

Please read and understand these safety instructions. Incorrect use can cause injury and will void EUROM's warranty.



### WARNING

- Do not use this heater in small rooms when they are occupied by persons not capable of leaving the room on their own, unless constant supervision is provided.
- To reduce the risk of fire, keep textiles, curtains, or any other flammable material a minimum distance of 1 m.



### CAUTION

Some parts of this product can become very hot and cause burns. Particular attention has to be given where children and vulnerable people are present.



### WARNING

In order to avoid overheating, do not cover the heater.

- Children of less than 3 years should be kept away unless continuously supervised.
- Children aged from 3 years and less than 8 years shall only switch on/off the appliance provided that it has been placed or installed in its intended normal operating position and they have been given supervision or instruction concerning use of the appliance in a safe way and understand the hazards involved. Children aged from 3 years and less than 8 years shall not plug in, regulate and clean the appliance or perform user maintenance.
- This appliance can be used by children aged from 8 years and above and persons with reduced physical, sensory or mental capabilities or lack of experience and knowledge if they have been given supervision or instruction concerning use of the appliance in a safe way and understand the hazards involved. Children shall not play with appliance. Cleaning and user maintenance shall not be done by children without supervision.
- Heater must not be located immediately below a socket-outlet.
- If the supply cord is damaged, it must be replaced by manufacturer, its service agent or similarly qualified persons in order to avoid a hazard.
- Do not use this heater in the immediate surroundings of a bath, a shower or a swimming pool.
- This heater is not suitable for installation in the bathroom.
- Do not use this heater if it has been dropped.
- Do not use if there are visible signs of damage to the heater.
- Use this heater on a horizontal and stable surface, or fix it to the wall, as applicable.

When using the Mon Soleil heater freestanding with the supplied plastic pedestals or in combination with the optionally available Freestanding support (article number 361278):

- Use this heater on a horizontal and stable surface.

The device is equipped with an overheating protection, which switches it off automatically in case of internal overheating. Switch the device off, unplug the power plug, remove the source of overheating, let it cool down and use as normal. Do not use the device if the source of overheating cannot be traced or if the problem persists, but always contact your supplier.

Special warnings for Mon Soleil DSP 360 Frame and Mon Soleil DSP 720 Frame models when installed in a suspended ceiling grid:

- The appliance shall, under no circumstances, be covered with insulating material or similar material.
- Joist, beams and rafters shall not be cut or notched to install the appliance.

## General safety instructions



### WARNING

- Prevent splashing water on or in the device.
- Do not immerse any part of the device in water or other liquids.
- Never insert fingers or other objects into the openings of the device.
- Do not expose the device to strong vibrations or mechanical stress.



### WARNING

The device becomes very hot during use. Do not touch the device during use or within five minutes after use.



### CAUTION

Do not cover the device during usage or after use while the device is still hot. To reduce the risk of fire, keep textiles, curtains, tent canvasses and other flammable material at a minimum distance of 1 meter from the device.

## Safety during operation



### WARNING

Do not use the device:

- outdoors or in a small space ( $< 7 \text{ m}^3$ );
- lying, leaning or standing without the pedestals correctly mounted;
- if any parts are dirty or wet;
- near large objects, like behind a door, under a shelf or near a cupboard;
- near or in a dusty and dirty environment, like a construction site;
- near flammable materials, liquids or fumes, e.g. in a shed, stable or green house;
- near other heat sources and open fire;
- with an appliance that automatically switches the device on, such as a timer, dimmer or any other device.

If the device, the electric cable or plug shows damage or is malfunctioning, immediately take the appliance out of use and disconnect the power supply.

## Warranty

EUROM offers a 60-month warranty on this device from the date of purchase. The warranty does not cover wear and tear from normal use. The warranty expires if a defect is the result of unintentional or careless use of the device. The manufacturer, importer and supplier are not liable for incorrect connections.

## Introduction

Thank you for choosing this EUROM device. You have purchased a quality device that you will enjoy for many years. Using this device with respect and care will reduce the risk of personal injury or material damage.



### CAUTION

It is important to read and understand this instruction manual before assembling, installing and using the device.

This manual describes the correct and safe use of this device. Keep this manual for future reference. The manual is an essential part of the device and must be given to the new owner upon resale or exchange. This manual has been compiled with the utmost care. Nevertheless, we reserve the right to improve and adjust this manual at any time. The images used may differ.

The following symbols and terms are used in this manual to alert the reader to safety issues and important information:



### WARNING

Indicates a hazardous situation which, if the safety instructions are not followed, can lead to injuries to the operator or bystanders, light and/or moderate damage to the product or to the environment.



### CAUTION

Indicates a hazardous situation which, if the safety instructions are not followed, can lead to light and/or moderate damage to the product or to the environment.

## Identification

<b>EUROM</b> <sup>®</sup> POWERFUL PRODUCTS SINCE 1974	<b>Mon Soleil DSP Frame *** Wifi</b> Art. nr. ***** Batch. *****		
<b>220-240V ~ 50-60Hz - *** Watt</b>			
EUROMAC B.V. - KOKOSSTRAAT 20 - 8281 JC - GENEMUIDEN - NETHERLANDS - info@eurom.nl			

Figure 1.

## Specifications

Type:	Mon Soleil DSP 360 Frame Wi-Fi	Mon Soleil DSP 600 Frame Wi-Fi	Mon Soleil DSP 720 Frame Wi-Fi
Product size:	59.5 x 59.5 cm	59.5 x 99.5 cm	59.5 x 119.5 cm
Weight:	4.4 kg	6.8 kg	8.1 kg
Voltage:	220-240V / 50-60Hz	220-240V / 50-60Hz	220-240V / 50-60Hz
Power:	310-360W	520-600W	620-720W
Protection rating:	IP20	IP20	IP20
Protective class:	Class I	Class I	Class I

Hereby, Euromac b.v. declares this product is in compliance with Directive 2014/53/EU.

The full text of the EU declaration of conformity is available at the following internet address: [www.eurom.nl/declaration-of-conformity](http://www.eurom.nl/declaration-of-conformity).

- Wi-Fi and Bluetooth Frequency Band: 2.4 ~ 2.4835GHz
- Maximum radio-frequency power transmitted in this frequency band(s):
  - Wi-Fi: 17.5dBm
  - Bluetooth: 6.5dBm

## Description

The Mon Soleil DSP Frame Wifi is an easy-to-use electric heater for indoor use. The device can be mounted on a wall or ceiling or freestanding with the supplied plastic pedestals. The Mon Soleil DSP Frame Wifi can be used with the Eurom Smart App and can be programmed on a day and a week timer.

## Unboxing

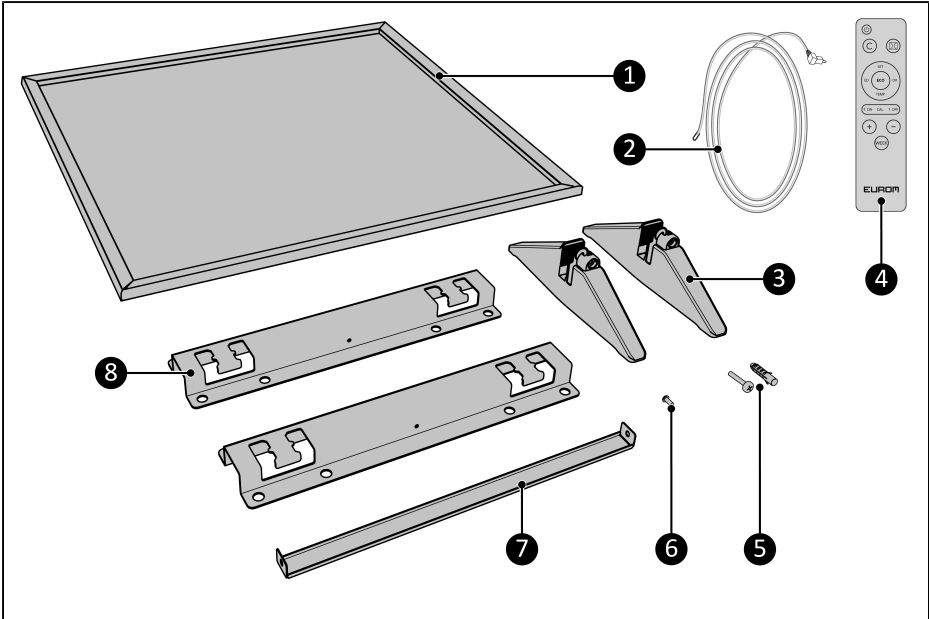

Figure 2.

No.	Description	No.	Description
1	The heater	5	Mounting screws and wall plugs (8x)
2	External temperature sensor	6	M4 screws 12 mm (2x)
3	Pedestals with pre-mounted screws (2x)	7	Distance holder for brackets
4	Remote control	8	Brackets (2x)

### Control panel and LED display

The LED screen automatically rotates when the device is turned. The control buttons remain the same.

1. Display
2. Plus button
3. Minus button
4. Power indication
5. Wi-Fi indication
6. Open window indication
7. Heating indication
8. Wi-Fi thermostat indication
9. Remote control receiver
10. Mode button
11. ON/OFF button

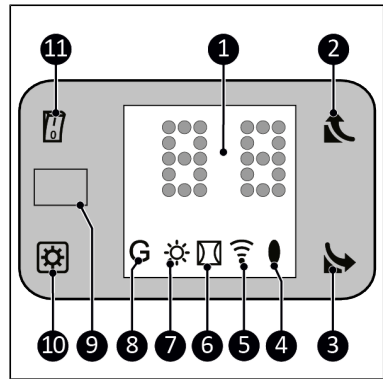

Figure 3.

## Remote control



### ATTENTION

Batteries not included.

1. Open window button
2. SET button
3. OK button
4. ECO button
5. Calibration button
6. TIME OFF button
7. Minus button
8. WEEK button
9. Plus button
10. TIME ON button
11. Temperature button
12. EDIT button
13. Cancel button
14. ON/OFF button

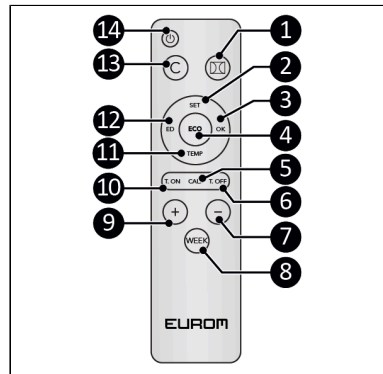

Figure 4.

## Transport and storage

- Clean the device before storing it.
- Transport the device in an upright position.
- Store the device in an upright position, in its original packaging, in a cool, dry and dust-free area.

## Assembly



### WARNING

Plastic bags can be dangerous. To avoid danger of suffocation, keep this bag away from babies and children.

The device is packed in one box. Remove all packaging material and check that the device is not damaged. Do not use the device if it is damaged, but always contact your supplier. Keep the packaging for safe storage and transport.

## Mounting



### WARNING

The wall or ceiling used for mounting must be made from non-flammable material and should be able to withstand a minimum temperature of 125 °C.



### CAUTION

Make sure to use suitable fastening materials, depending on the surface. The provided anchor bolts are suitable for a brick wall. Never block the space between the device and the wall or ceiling.

The device can be mounted in four ways:

- vertically to the wall;
- horizontally to the wall;
- freestanding with the pedestals mounted;
- to a ceiling.

In all four of the placements, the control panel should be visible and operable.

### Wall mounting

1. Place the device on a vertical and solid wall. Use a level when placing the device.
2. Place the device (horizontally or vertically) with a minimum distance of:
  - A. 30 cm from the side walls;
  - B. 30 cm from the ceiling;
  - C. 20 cm from the floor;
  - D. 50 cm clearance on the front side.
3. Do not mount the device immediately over, near or below a socket outlet.

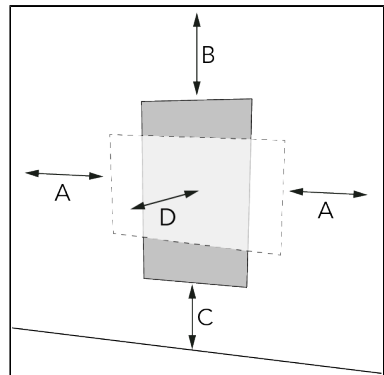

Figure 5.

## Assembling the bracket



### CAUTION

Make sure the openings of both brackets point upwards, see Figure 6 and Figure 7 for reference.

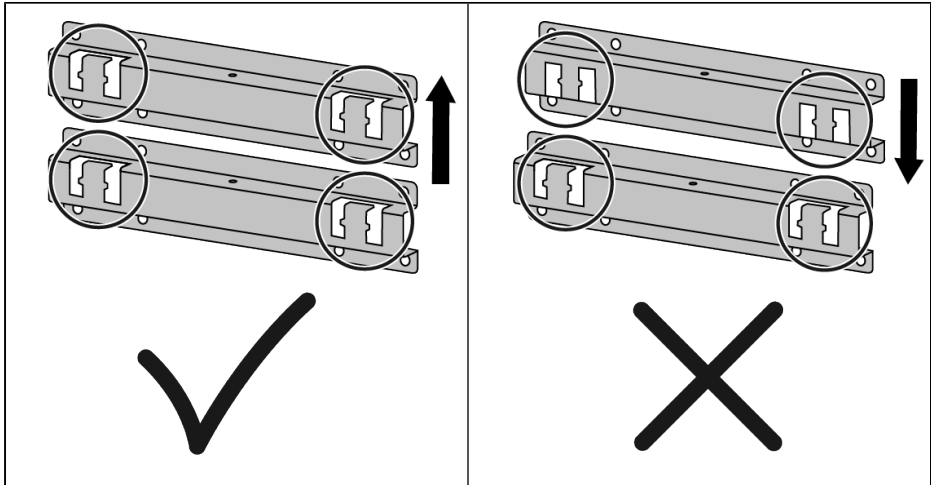

Figure 6.

1. Mount the distance holder (Figure 7, pos. 2) to the brackets (Figure 7, pos. 1) using the 2 M4 12mm screws (Figure 7, pos. 3).

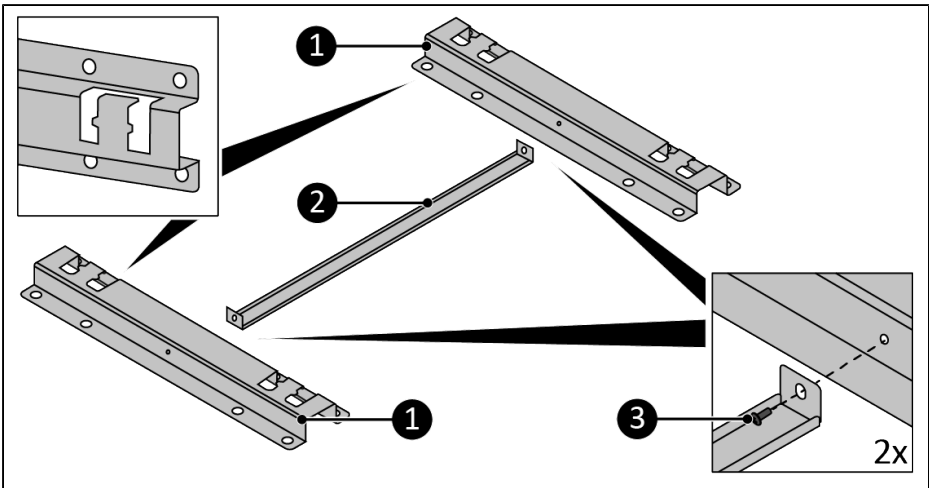

Figure 7.

### Vertical wall mounting

1. Place the bracket against the wall and mark the eight holes. Make sure to place the bracket upright, with the bracket openings at the top.
2. Drill eight 10 mm holes at the marked spots.
3. Place wall plugs (Figure 8, pos 1).
4. Screw and tighten the wall bracket (Figure 8, pos. 2) to the wall with eight large screws using a Phillips screwdriver (Figure 8, pos. 3).
5. Place the device brackets (Figure 9, pos. 3) over the wall bracket (Figure 9, pos. 1).
6. Slide the device (Figure 9, pos. 2) into the openings of the wall bracket (Figure 9, pos. 1).
7. Make sure the control panel is located at the bottom of the device.
8. To remove the device, lift and slide it in the opposite direction.

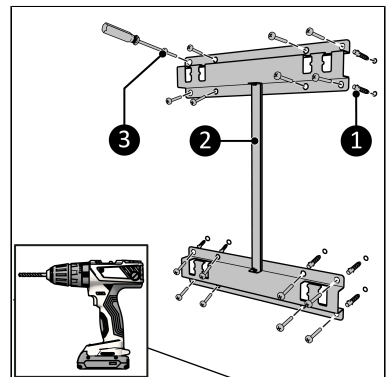

Figure 8.

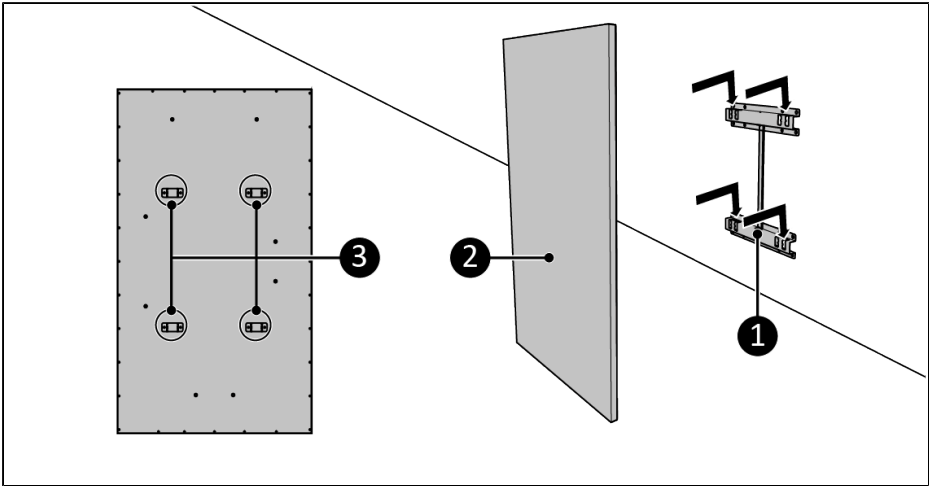

Figure 9.

### Horizontal wall mounting

1. Place the bracket against the wall, with the bracket openings at the left and mark the eight holes (Figure 10).
2. Drill eight 10 mm holes at the marked spots.
3. Place wall plugs (Figure 10, pos. 3).
4. Screw and tighten the wall bracket (Figure 10, pos. 1) to the wall with eight large screws using a Phillips screwdriver (Figure 10, pos. 2).
5. Place the device brackets (Figure 11, pos. 3) over the wall bracket (Figure 11, pos. 1).
6. Slide the device (Figure 11, pos. 2) into the openings of the wall bracket (Figure 11, pos. 1).
7. Make sure the control panel is located at the topside of the device.
8. To remove the device, lift and slide it in the opposite direction.

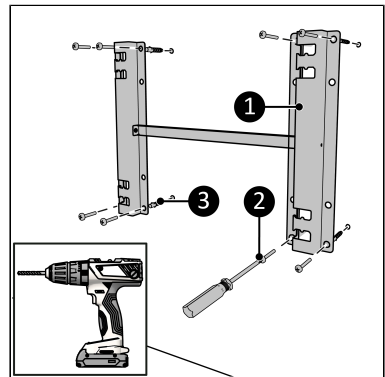

Figure 10.

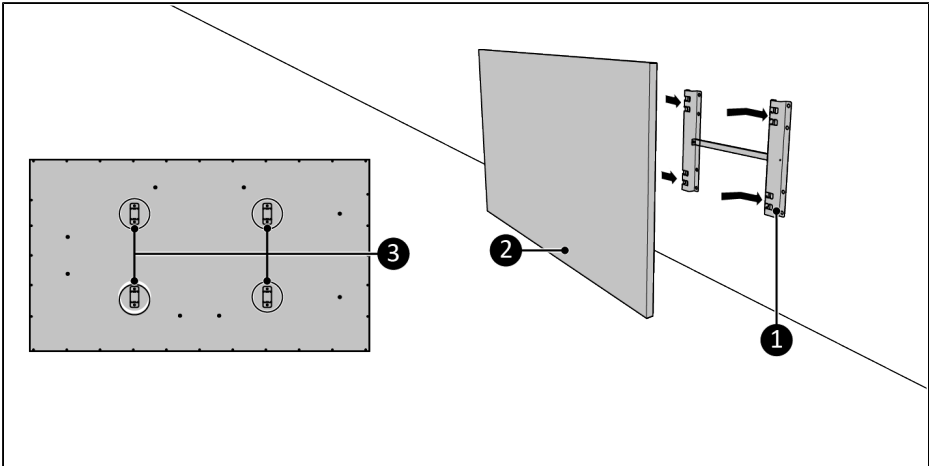

Figure 11.

### Mounting the pedestals



**WARNING**

The surface on which the device is placed must be made from non-flammable material and should be able to withstand a minimum temperature of 125 °C.



**WARNING**

Never place the device on surfaces such as beds or deep-pile carpet as openings could be blocked.



**WARNING**

Never use the device before it is correctly mounted. Be sure the control panel is on the topside when the device is used freestanding with the pedestals mounted.

1. Lay the device down on a steady, soft surface ( Figure 12, pos. 2).
2. Screw and tighten the pedestals (Figure 13, pos. 1).
3. Place the device on a horizontal, solid and non-flammable surface.
4. Place the device with a minimum clearance distance (Figure 14) of:
  - A. 100 cm on the top side;
  - B. 50 cm on the sides;
  - C. 30 cm on the back side;
  - D. 50 cm on the front side.
5. Do not place the device immediately below a socket outlet.

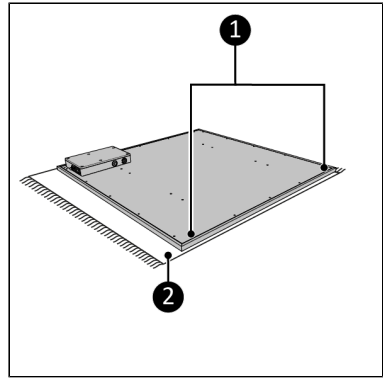

Figure 12.

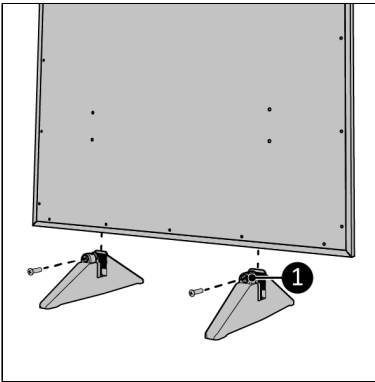

Figure 13.

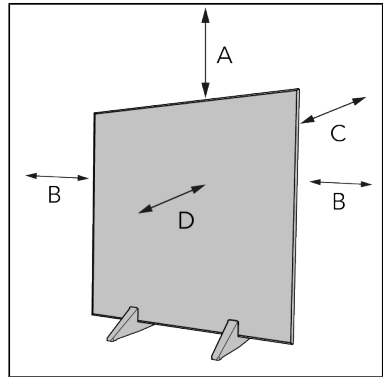

Figure 14.

### Ceiling mounting



#### CAUTION

When mounting the device to the ceiling, it is strongly recommended to use the Wi-Fi thermostat for optimal temperature control.



#### CAUTION

When mounting the device to the ceiling, it is absolutely necessary to calibrate the device panel. See chapter Temperature calibration (Optional) for explanation on the calibration function.

1. Place the device on a non-flammable and solid ceiling.
2. Place the device with a minimum distance (Figure 15) of:
  - A. 30 cm from the side walls;
  - B. 185 cm from the floor.
3. Do not mount the device immediately over, near or below a socket outlet.
4. Place the bracket against the ceiling and mark the eight holes (Figure 16).
5. Drill eight 10 mm holes at the marked spots.
6. Place wall plugs (Figure 16, pos. 3).
7. Screw and tighten the bracket (Figure 16, pos. 1) to the ceiling with eight large screws using a Phillips screwdriver (Figure 16, pos. 2).
8. Place the device brackets (Figure 17, pos. 3) over the ceiling bracket (Figure 17, pos. 1).
9. Slide the device (Figure 17, pos. 2) into the openings of the ceiling bracket (Figure 17, pos. 1).
10. Make sure the heater is properly secured in the ceiling bracket.
11. To remove the device, lift and slide it in the opposite direction.

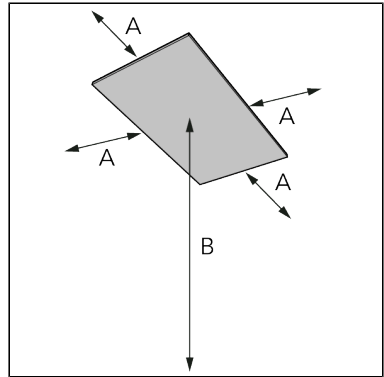

Figure 15.

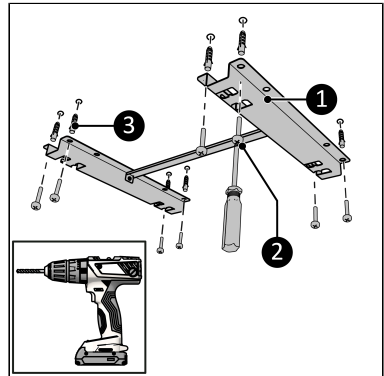

Figure 16.

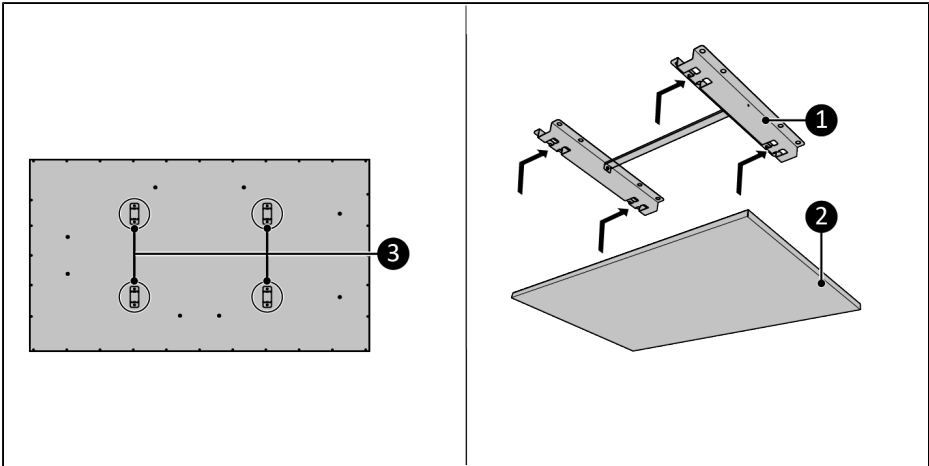

Figure 17.

### Ceiling mounting in a suspended ceiling grid

(This applies only to the Mon Soleil DSP 360 Frame and the Mon Soleil DSP 720 Frame.)



#### CAUTION

The Mon Soleil DSP Frame infrared panels can only be used in a suspended ceiling frame of 60x60cm (Mon Soleil DSP 360 Frame) or 60x120 cm (Mon Soleil DSP 720 Frame).



#### CAUTION

If the infrared panel does not fit perfectly in the suspended ceiling grid. Do not proceed and never change anything on the suspended ceiling grid. Changes to the ceiling grid will weaken the system, causing the infrared panel not to mount securely enough.



#### CAUTION

When the infrared panels are installed, ensure that they are always accessible and can be quickly disconnected from the mains.

1. Remove the ceiling plate (Figure 18, pos. 1) from where you wish to install the device.
2. Make sure there is at least 25 cm space between the suspended ceiling and the ceiling.
3. Carefully place the device (Figure 18, pos. 2) in the suspended ceiling grid (Figure 18, pos. 1).
4. Connect the device to the power supply.

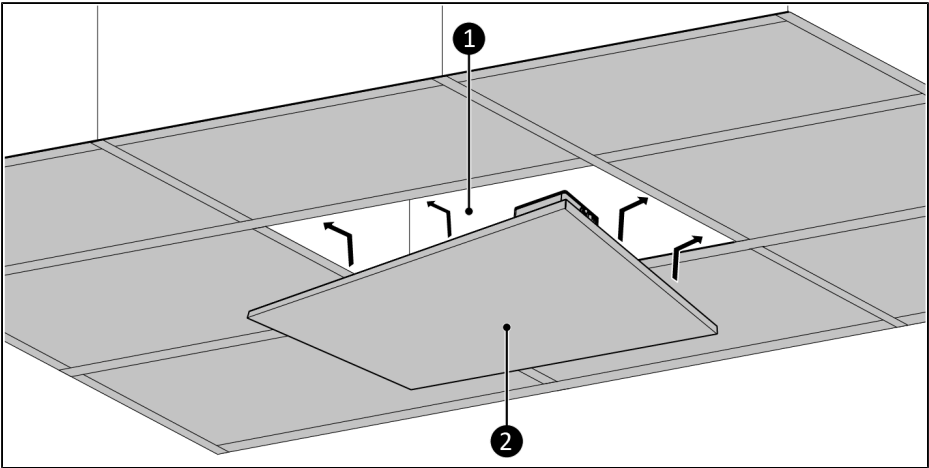

Figure 18.

The external temperature sensor can be used to measure the correct temperature in the room. Guide this temperature sensor through a small hole in the suspended ceiling to measure the temperature of the room. For optimal temperature control, however, we strongly recommend using the optionally available Eurom Wi-Fi thermostat.

### Temperature sensor



#### CAUTION

For accurate temperature measuring use the external temperature sensor.

1. Disconnect the power plug from the power outlet.
2. Connect the external temperature sensor connector (Figure 19, pos. 1) to the sensor plug.
3. Place the temperature sensor approximately 2 meters away from the device.

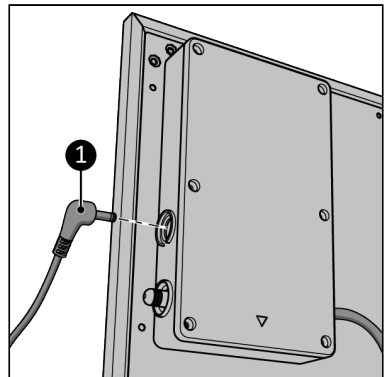

Figure 19.

## Installation



### WARNING

- Do not put the power plug into the wall socket before the device is mounted or placed correctly.
- Do not use an extension cable; this can cause overheating and fire. If using an extension cable is unavoidable, make sure it is undamaged and earthed. Use an extension cable with a minimum power of 1000 Watt. Always unwind the extension cable completely to prevent overheating.



### CAUTION

Make sure that the main voltage is the same as indicated on the identification label of the device. All electrical connections must stay dry under all circumstances.

1. Make sure the device is correctly mounted.
2. Insert the power plug (Figure 20, pos. 1) into an earthed wall socket that is easily accessible. Use an earthed wall socket with a minimum power of 1000 Watt.
3. Make sure the power cable does not come into contact with the device.

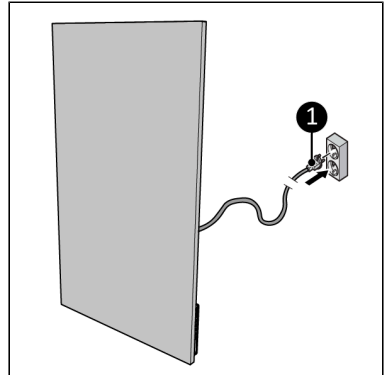

Figure 20.

## Remote control

1. Remove the battery cover (Figure 21, pos. 1).
2. Insert two batteries (AAA 1.5 V) (Figure 21, pos. 2) as indicated in the battery compartment. Make sure to insert the batteries correctly.
3. Replace the cover.

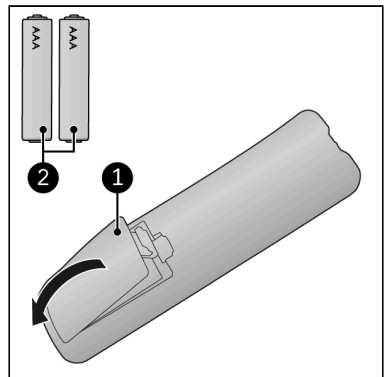

Figure 21.

## Operation



### WARNING

Before every use, make sure that:

- you operate the device with dry hands;
- the device is clean and dry;
- the device is not damaged;
- the device is not covered or blocked;
- the device is securely mounted to the wall or ceiling.



### CAUTION

When the device is turned on or off, it may emit a sound. This is the material expanding and shrinking during heating and cooling down.



### CAUTION

The day and time settings will be reset to default if the device is switched off, using the ON/OFF switch, or is unplugged. The week timer set via the remote control is automatically set to OFF.

If the device is used with the Eurom Smart App the time and day settings will automatically be correct.

1. Press the ON/OFF button on the control panel (Figure 3, pos. 11) or on the remote control.
2. The display (Figure 3, pos. 1) will first show the set temperature for 3 seconds followed by the ambient temperature.

## Device control

### Set the temperature

1. Press the Plus or Minus button to set the desired temperature, from 0 °C to 45 °C.
2. The device starts heating when the set temperature is higher than the ambient temperature and stops heating when the ambient temperature reaches the set temperature. The heating indicator will appear and disappear accordingly.
3. The display shows the ambient temperature.

### Set the day and time

(This is not needed when using the Eurom Smart App. If the device is used with the Eurom Smart App the time and day settings will automatically be correct.)

1. Make sure the heating indicator is not visible. The device should not be heating.
2. Press the Mode button, HH appears on the display.
3. Press the Plus or Minus button to select the current day, from 1 (Monday) to 7 (Sunday).
4. Press the Mode button, H1 appears on the display.
5. Press the Plus or Minus button to select the current hour, from 0 to 23.
6. Press the Mode button, H2 appears on the display.

7. Press the Plus or Minus button to select the current minute, from 0 to 59.
8. Press the Mode button, the ambient temperature appears on the display, the day and time are set.

### **Checking the day and time**

1. Make sure the heating indicator is visible, the device should be heating.
2. Press the Mode button briefly and repeatedly to check:
  - the day - HH;
  - the hour - H1;
  - the minutes - H2.

### **Remote control**

The remote control should be directed towards the display in order to operate the device using the remote control.

### **Set the temperature**

1. Press the Plus or Minus button to set the desired temperature, from 0 °C to 45 °C.
2. The device starts heating when the set temperature is higher than the ambient temperature and stops heating when the ambient temperature reaches the set temperature. The heating indicator will appear and disappear accordingly.
3. The display shows the ambient temperature.

### **Set the day and time**

1. Make sure the heating indicator is not visible. The device should be ON but not heating.
2. Press and hold the SET button until HH appears on the display.
3. Press the Plus or Minus button to select the current day, from 1 (Monday) to 7 (Sunday).
4. Press the SET button, H1 appears on the display.
5. Press the Plus or Minus button to select the current hour, from 0 to 23.
6. Press the SET button, H2 appears on the display.
7. Press the Plus or Minus button to select the current minute, from 0 to 59.
8. Press the SET button, the ambient temperature appears on the display, the day and time are set.

### **Check the day and time**

1. Make sure the heating indicator is visible, the device should be heating.
2. Press the SET button briefly and repeatedly to check:
  - the day – HH;
  - the hour – H1;
  - the minutes – H2.

### **Open window mode**

1. Press the Open window button to activate. The Open window indicator appears on the display. The Open window mode can only be switched on or off with the remote control, even when your device is connected to the Eurom Smart App.
2. When the ambient temperature decreases 5°C or more within 15 minutes, the device will go in standby mode and the Open window indicator starts flashing on the display.
3. Press the Open window button to deactivate.

## ECO mode

The Eurom Smart App has an ECO button. ECO mode maintains the room temperature at 16°C.

1. Press the ECO button to activate; EC appears on the screen.
2. Press the ECO button to deactivate.

If the device is working in ECO mode and a timer setting becomes active, the device will start working according to the timer setting. When the timer setting ends, the device will not return to ECO mode.

## Set the week timer

The week timer can be set via the remote control, but is easier to set using the Eurom Smart App. If in the week timer setting mode no button is pressed for ten seconds, it will reset and must start all over again. Make sure to not create any contradicting timer settings.

1. Press and hold the WEEK button until UU appears and flashes on the display.
2. Press the SET button; ON/OFF starts flashing on the display.
3. Press the Plus or Minus button to select:
  - ON – Timer on;
  - OFF – Timer off.
4. Press the OK button; UU appears on the display.
5. Press the SET button.
6. Press the Plus or Minus button to select:
  - 01 – all timer settings are executed once only. This can only be planned for the current week (U1 to U7). On Sunday (U7) at 23:59, all 01 timer settings are deleted;
  - 99 – all timer settings are executed limitlessly.
7. Press the OK button; UU appears on the display.
8. Press the SET button; U1 appears on the display.
9. Press the Plus or Minus button to select the desired day, from U1 (Monday) to U7 (Sunday).
10. Press the OK button; the selected day appears on the display.
11. Press the EDIT button; 01 appears on the display.
12. Press the Plus or Minus button to select a number for this timer, from 1 to 4. Four means the maximum timer settings per day. If a new timer is set with the same number, the old timer will be overwritten.
13. Press the OK button; the selected number appears on the display.
14. Press the Temperature button; HP appears on the display.
15. Press the Plus or Minus button to select the desired temperature, from 0 °C to 45 °C.
16. Press the OK button; the selected temperature appears on the display.
17. Press the TIME ON button; HE appears on the display.
18. Press the Plus or Minus button to select the desired start time, from 00:00 to 23:00 in whole hours.
19. Press the OK button; the selected start time appears on the display.
20. Press the TIME OFF button; HF appears on the display.
21. Press the Plus or Minus button to select the desired stop time, from 00:00 to 23:00 in whole hours.
22. Press the OK button; the selected stop time appears on the display.
23. Repeat as desired.

### Remove all week timer settings

1. Press and hold the WEEK button until UU appears and flashes on the display.
2. Press the Cancel button to erase all timer settings.

### Remove all week timer settings for a specific day

1. Press and hold the WEEK button until UU appears and flashes on the display.
2. Press the SET button; ON/OFF appears on the display.
3. Press the SET button; 01/99 appears on the display.
4. Press the SET button; U1 appears on the display.
5. Press the Plus or Minus button to select the desired day, from 1 (Monday) to 7 (Sunday).
6. Press the Cancel button to erase all timer settings for the selected day.

### Remove a specific timer setting

1. Press and hold the WEEK button until UU appears and flashes on the display.
2. Press the SET button; ON/OFF appears on the display.
3. Press the SET button; 01/99 appears on the display.
4. Press the SET button; U1 appears on the display.
5. Press the Plus or Minus button to select the desired day, from 1 (Monday) to 7 (Sunday).
6. Press the Edit button.
7. Press the Plus or Minus button to select the desired timer setting, from 1 to 4.
8. Press the Cancel button to erase the selected timer setting.

### Check the timer settings

1. Make sure the heating indicator is visible. The device should be heating.
2. Press the WEEK button briefly and repeatedly to check:
  - timer ON or timer OFF;
  - once only (01) or endlessly (99);
  - U1-U7, day of the week;
  - timer setting number of the day concerned (1, 2, 3 or 4);
  - set temperature;
  - start time in hours;
  - stop time in hours;
  - this is repeated for the next timer setting.

All 28 timer settings are shown, also the timer settings that have not been filled. The temperature of the non-filled timer settings is 20 °C.

### Eurom Smart App



#### CAUTION

Do not use the weekly timer created with the device at the same time as the weekly timer created with the Eurom Smart App. Timer settings created by the Eurom Smart App are not visible on the device display. Timer settings created on the device are not visible in the Eurom Smart App.

**CAUTION**

It is recommended to switch on Bluetooth on your smart phone when connecting your Eurom device for the first time. Doing so will make connecting quicker and easier.

The device can be operated using an app on a smartphone or tablet. The Eurom Smart App can be used to:

- switch the device on and off;
- regulate the temperature.

The app can also be used to set twenty on and off timer settings daily, on the weekly timer.

1. Open the Eurom Smart App manual with the QR code (Figure 22) or go to [www.eurom.nl/nl/manuals](http://www.eurom.nl/nl/manuals).
2. Complete the steps in the Eurom Smart App manual.
  - When the device is connected with Wi-Fi, the Wi-Fi symbol appears on the screen.
  - If the Wi-Fi symbol is blinking there is no connection.

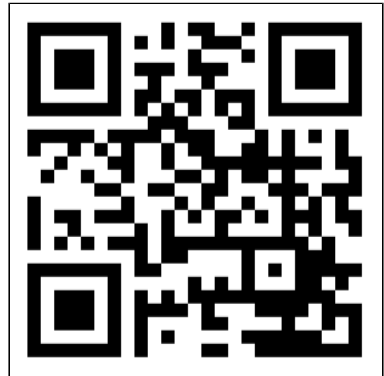

Figure 22.

**Smart Timer**

1. Create a schedule with days and times in the Eurom Smart App. Timer settings set in the app:
  - will be stored on the device;
  - will not be visible on the device;
  - will remain available if Wi-Fi disconnects;
  - will remain available if the device is switched off or unplugged;
  - can only be removed via the app.
2. Check the data in the app regularly.

**Reset Wi-Fi connection**

1. Press and hold the Mode button until a beep sounds. Existing connections will be deleted. The Wi-Fi symbol will start blinking and a new connection can be made.

**Switch off Wi-Fi connection**

1. Verify that the heating indicator is not visible. The device should be on but not heating.
2. Press and hold the ON/OFF button until a beep sounds. The Wi-Fi is switched off and the Wi-Fi symbol will disappear from the screen.
3. Press and hold the ON/OFF button until a beep sounds. The Wi-Fi is switched on and the Wi-Fi symbol will appear on the screen.

### Wi-Fi thermostat ready (Optional)

This device can be connected with the optional Wi-Fi thermostat. The temperature is measured at the Wi-Fi thermostat instead of the device. This ensures an optimized comfort level. The device will keep heating until the set temperature of the Wi-Fi thermostat is reached.

It is possible to connect multiple devices to a single Wi-Fi thermostat. All the connected devices will switch on and off simultaneously.

To use the Wi-Fi thermostat:

1. Place the Wi-Fi thermostat in any power socket.
2. Download the Eurom Smart App on a (mobile) device.
3. Open the Eurom Smart App.
4. Add the Wi-Fi thermostat and other devices to the Eurom Smart App.
5. Go to the device(s) and press the Pairing Button to pair the device(s) to the Wi-Fi thermostat.

The device is connected to the Wi-Fi Thermostat. The G-sign illuminates in the Eurom Smart app and on the device. Now you can enjoy the optimized comfort level of permanent electric heating.

### Temperature calibration (Optional)



#### CAUTION

When the device is mounted on the ceiling, the internal temperature sensor is not able to measure the temperature in the room correctly as heat rises. Therefore, it is absolutely necessary to calibrate the device panel when it is mounted on the ceiling.

### Calibrating the device

1. Set the desired temperature to 45 °C (max. temperature).
2. Let the device heat without interruptions for 120 minutes.
3. Place a digital room thermometer (not included) at a central place where the desired temperature should be achieved; recommended is 150 cm from the floor.
4. After 120 minutes, calculate the difference between the external thermometer and the temperature shown on the display of the heater (press any button to reappear). For example: if the display shows 34 °C and the thermometer 20 °C, then the calibration can be calculated as follows: 34 (temperature display) minus 20 (temperature thermometer) plus 10 (standard correction) = 24.
5. Press the Calibration button on the remote control; a number appears on the display.
6. Press the Plus or Minus button to select the calibration number, from 00 to 28. In our example this is 24.
7. Press the OK button.
8. Unplug and plug back in to activate the calibration process.

## Calibration mode

- Every time the device is turned on and starts heating, the calibration process will be started. The device display will show CL and the Eurom Smart App will show Calibration in progress. The calibration process uses the calibration number to gradually adjust the measured temperature to the calibrated room temperature. This can take up to 80 minutes.

When the calibration is ready the display and the Eurom Smart App will show the calibrated room temperature. When the calibration value is correctly measured the calibrated room temperature will be approximately the same as the real room temperature.

- When the heater stops heating, the calibration process will start in opposite direction (cooling calibration). The device display will show CL and the Eurom Smart App will show Calibration in progress. The cooling calibration process can take up to 110 minutes.
- Do not switch off the heater during a calibration process, breaking off the calibration process will cause a temporary difference between the calibrated room temperature and the real room temperature. In this case the heater will not heat up to the temperature you have set. If by accident the calibration process is cancelled, the difference will resolve itself over time.

For ceiling-mounted use it is recommended to use the Eurom Wi-Fi thermostat (365764, 365771 (Swiss plug) & 365788 (USB-C)) for optimal temperature control. The Wi-Fi thermostat measures the room temperature and communicates the information via Wi-Fi to the device.

## After operation



### CAUTION

Do not use the power cable to unplug or carry the device. Do not wind the power cable too tightly or in sharp corners. Do not wrap the power cable around the device.

1. Make sure the device is OFF by pressing the ON/OFF button (Figure 3, pos. 11).
2. Disconnect the power plug from the power outlet.
3. Let the device cool down before touching it.
4. Wind the power cable.
5. Remove the batteries from the remote control (Figure 21).

## Maintenance



### WARNING

Do not perform any repairs or modifications to this device.

Maintenance and repairs must be carried out by a EUROM authorized professional. If the electric cable and/or electric plug is damaged, it should be replaced by the manufacturer or its service employee or persons with similar qualifications to prevent risks.

## Cleaning



### WARNING

The device becomes very hot. Make sure the device is turned off, unplugged and completely cooled down.



### CAUTION

Do not use:

- scouring pads;
- hard brushes;
- flammable, aggressive or chemical cleaning products.

Prevent water from entering the device. Do not immerse any part of the device in water or other liquids.

It is recommended to clean the device after each use and prior to storage.

1. Wipe the device with a damp, clean, soft, lint-free cloth or a soft brush.
2. Let the device dry completely prior to use and storage.

## Disposal



This marking indicates that this product should not be disposed of with other household waste throughout the EU. Batteries and rechargeable batteries that are not permanently installed in the appliance must be removed and disposed of separately before disposal. To prevent possible harm to the environment or human health from uncontrolled waste disposal, recycle it responsibly to promote the sustainable reuse of material resources. To return your used device, please use the return and collection systems or contact the retailer where the product was purchased. They can take this product for environmentally safe recycling.

## Attachments

Information requirement for the electric local space heaters					
Model identifier: Mon Soleil DSP Frame 360 Wi-Fi					
Item	Symbol	Value	Unit	Item	Unit
<b>Heat output</b>				<b>Type of heat output/room temperature control (select one)</b>	
Nominal heat output	Pnom	0.360	kW	single stage heat output and no room temperature control	no
Minimum heat output (indicative)	Pmin	N.A.	kW	two or more manual stages, no room temperature control	no
Maximum continuous heat output	Pmax,c	0.335	kW	with mechanic thermostat room temperature control	no
<b>Power consumption</b>				with electronic room temperature control	
In off mode	Po	N.A.	W	electronic room temperature control plus day timer	no
In standby mode	Psm	0.44	W	electronic room temperature control plus week timer	yes
In idle mode	Pidle	0.44	W	<b>Other control options (multiple selections possible)</b>	
In network standby	Pnsm	0.68	W	room temperature control, with presence detection	no
Standby mode with display of information or status			yes	room temperature control, with open window detection	yes
Seasonal space heating energy efficiency in active mode	$\eta_{S,on}$	94.0	%	distance control option	yes
				adaptive start control	no
				working time limitation	yes
				black bulb sensor	no
				self-learning functionality	no
				control accuracy	no
Contact details	Eurom - Kokosstraat 20 - 8281 JC - Genemuiden - The Netherlands				

<b>Information requirement for the electric local space heaters</b>					
Model identifier: Mon Soleil DSP Frame 600 Wi-Fi					
Item	Symbol	Value	Unit	Item	Unit
<b>Heat output</b>				<b>Type of heat output/room temperature control (select one)</b>	
Nominal heat output	P <sub>nom</sub>	0.600	kW	single stage heat output and no room temperature control	no
Minimum heat output (indicative)	P <sub>min</sub>	N.A.	kW	two or more manual stages, no room temperature control	no
Maximum continuous heat output	P <sub>max,c</sub>	0.578	kW	with mechanic thermostat room temperature control	no
<b>Power consumption</b>				with electronic room temperature control	
In off mode	P <sub>o</sub>	N.A.	W	electronic room temperature control plus day timer	no
In standby mode	P <sub>sm</sub>	0.44	W	electronic room temperature control plus week timer	yes
In idle mode	P <sub>idle</sub>	0.44	W	<b>Other control options (multiple selections possible)</b>	
In network standby	P <sub>nsm</sub>	0.68	W	room temperature control, with presence detection	no
Standby mode with display of information or status			yes	room temperature control, with open window detection	yes
Seasonal space heating energy efficiency in active mode	η <sub>S,on</sub>	94.0	%	distance control option	yes
				adaptive start control	no
				working time limitation	yes
				black bulb sensor	no
				self-learning functionality	no
				control accuracy	no
Contact details	Eurom - Kokosstraat 20 - 8281 JC - Genemuiden - The Netherlands				

<b>Information requirement for the electric local space heaters</b>					
Model identifier: Mon Soleil DSP Frame 720 Wi-Fi					
Item	Symbol	Value	Unit	Item	Unit
<b>Heat output</b>				<b>Type of heat output/room temperature control (select one)</b>	
Nominal heat output	P <sub>nom</sub>	0.720	kW	single stage heat output and no room temperature control	no
Minimum heat output (indicative)	P <sub>min</sub>	N.A.	kW	two or more manual stages, no room temperature control	no
Maximum continuous heat output	P <sub>max,c</sub>	0.685	kW	with mechanic thermostat room temperature control	no
<b>Power consumption</b>				with electronic room temperature control	
In off mode	P <sub>o</sub>	N.A.	W	electronic room temperature control plus day timer	no
In standby mode	P <sub>sm</sub>	0.44	W	electronic room temperature control plus week timer	yes
In idle mode	P <sub>idle</sub>	0.44	W	<b>Other control options (multiple selections possible)</b>	
In network standby	P <sub>nsm</sub>	0.68	W	room temperature control, with presence detection	no
Standby mode with display of information or status			yes	room temperature control, with open window detection	yes
Seasonal space heating energy efficiency in active mode	η <sub>S,on</sub>	94.0	%	distance control option	yes
				adaptive start control	no
				working time limitation	yes
				black bulb sensor	no
				self-learning functionality	no
				control accuracy	no
Contact details	Eurom - Kokosstraat 20 - 8281 JC - Genemuiden - The Netherlands				





---

Kokosstraat 20, 8281 JC Genemuiden, The Netherlands

T: (+31) 038 385 43 21

E: [info@eurom.nl](mailto:info@eurom.nl)

I : [www.eurom.nl](http://www.eurom.nl)

---

Model: Mon Soleil DSP Frame Wi-Fi Date: 16/09/2025

Version: v5.0

**EUROM**<sup>®</sup>

POWERFUL PRODUCTS SINCE 1974